

HITACHI

# Light Commercial range of Air Conditioners

Ductable Air Conditioners  
Concealed Air Conditioners  
Flexi Split Air Conditioners  
Cassette Air Conditioners



Cooling & Heating



# INDEX

---

03 Introduction

---

07 Ductable range of air conditioners

---

15 Concealed split air conditioners

---

17 Flexi split air conditioners

---

21 Cassette air conditioners

---

23 Specifications

---

---

# air, the essence of life

Invisible, silent and life-giving, air makes our entire world possible. It surrounds us, continuously energizing, cooling and warming. It can be unpredictable and sometimes challenging, but when air is in harmony with us, everything seems that much easier.

This is our vision.

To create the air that makes life better



---

# Born in Japan with a global presence

Since 1952, Hitachi Cooling & Heating has been helping make life more harmonious for people around the world. Today, our long heritage of precise Japanese engineering ensures that no detail is overlooked in our quest to create Living Harmony.

The technology of the future with expertise from the past.

Japanese technology designed for India.

14 factories across the globe.



---

## air made for you by air Xperts

At Hitachi Cooling & Heating, we understand the power of air and what it can do to elevate the environment of one's home and business. With our unparalleled Japanese heritage, we are constantly evolving and innovating to create cutting-edge products that make the best use of air and enable you to become the **air Xpert.**



## Become an air Xpert and turn your dreams into reality

We believe in going the extra mile to turn your dreams into reality. Which is why we bring together our knowledge, technology and expertise to create air conditioning solutions that can help your business grow. Presenting our latest range of Light Commercial Air Conditioners. Experience the future of air conditioning with our new enhanced product portfolio:

- **Ductable Air Conditioners**
- **Concealed Air Conditioners**
- **Flexi Split Air Conditioners**
- **Cassette Air Conditioners**

An ideal choice for hotels, bars, restaurants, hospitals, resorts, villas, corporate offices and more, you can now enjoy comfort even during extreme weather conditions.

With mesmerizing designs (for both indoor and outdoor units), it comes with additional advanced advantages like simple installation, ease of maintenance, space saving and power saving.

Ductable



Concealed

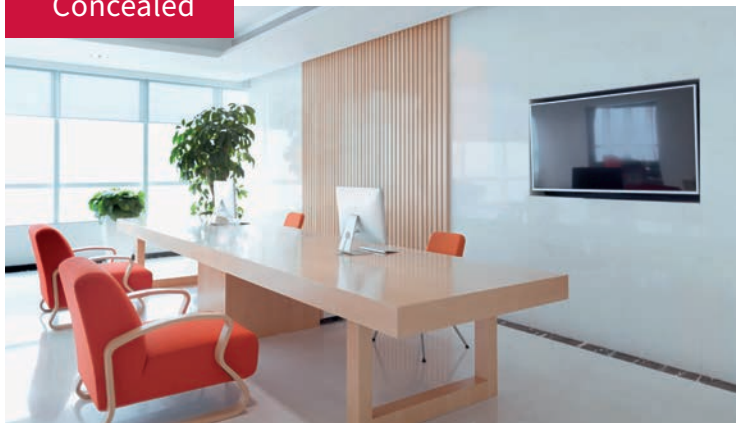

Flexi Split



Cassette



—  
Ductable range of  
air conditioners



Ingeniously engineered to maximize comfort, Ductable Range of Air Conditioners from Hitachi Cooling & Heating offers smart solutions to professionals like architects, HVAC consultants and more.

This range of air conditioners offer factory charged and tested refrigerant, ease of installation, ease of operations and safety features that are customized to best meet the consumers' needs.

## Unique characteristics



**Efficient**  
(Multi Compressor Unit)

- Part Load Operation
- Phase Starting of Compressor



**Comfortable**  
(Ease of Operation)

- Wireless Remote



**Proficient**  
(Enhanced Performance)

- Silent Operation
- Factory Charged Refrigerant



**Reliable**  
(Higher Ambient Temperature)

- Up to 52° C



**Safe**  
(Better Protection)

- Advanced Microprocessor Control



# More about Ductable air conditioners

## Tropical design



Designed for high ambient conditions, these units guarantee reliable operation even at 52°C outdoor air temperature. Apart from many other reliability tests, the units have been tested for 'maximum overload' condition at 52°C in our state-of-the-art test labs.

## Run time and equalisation of compressors



The inbuilt feature controls the run time of each compressor. The compressors are sequenced automatically so that the run hours of all compressors are equal. This ensures that no single compressor is subjected to extra wear and tear, thus ensuring longer life.

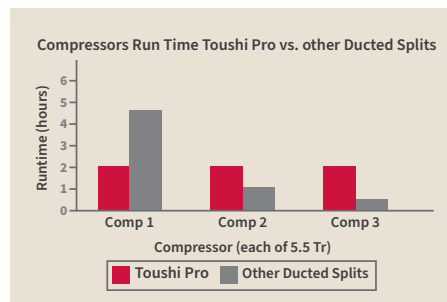

### Benefits

- Ensures equal running life of compressors by uniform usage
- Budget and monitor power consumption
- Trouble-free operation due to less wear & tear

## Scroll compressor



The Scroll Compressor used in the Toushi Pro unit is designed and engineered to deliver optimum cooling efficiency over the entire operating range. The simple internal suction and discharge valves enhance quieter operation, and considerably less moving parts of the unit ensure less wear and tear, which increases reliability when compared to conventional compressors. In addition, the scroll compressor provides better liquid handling capability, making an air conditioner more reliable.

### Benefits

- High volumetric efficiency
- Low sound level and low vibration
- Unloaded start and smooth operation



## Phase starting of compressor

The microprocessor embedded in controller provides a delay between the start-up of compressors of the same machine.

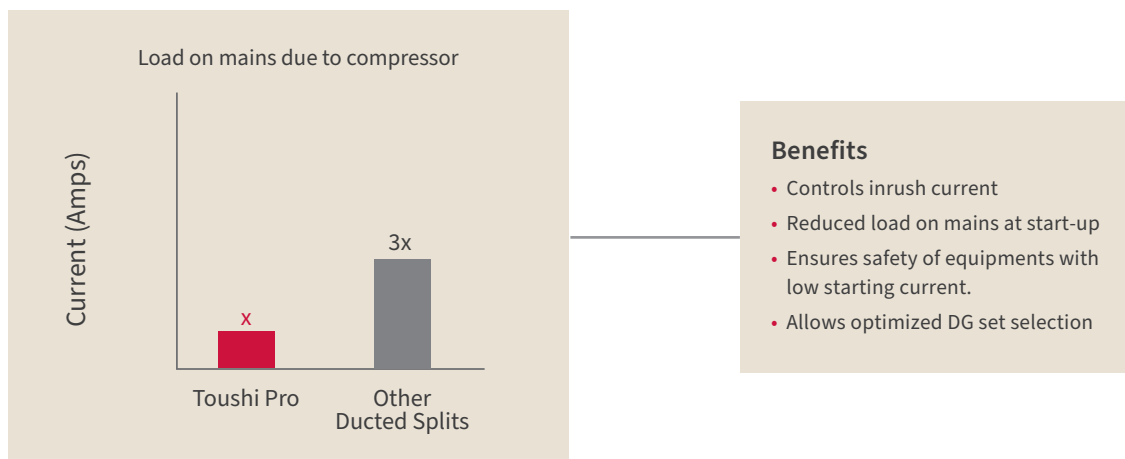

Illustration is for reference purpose with 7.5 TR multi-circuit ductable unit.

## Part load operation of multiple compressors

When the room temperature is close to the set temperature, the microprocessor shuts off the compressors automatically in a phased manner.

- Energy saving
- Prevents redundancy in operation
- Improves life cycle and performance
- Maintains comfort and optimal cooling

**Benefit**  
Saves power to avoid overcooling, which directly saves the operating cost.

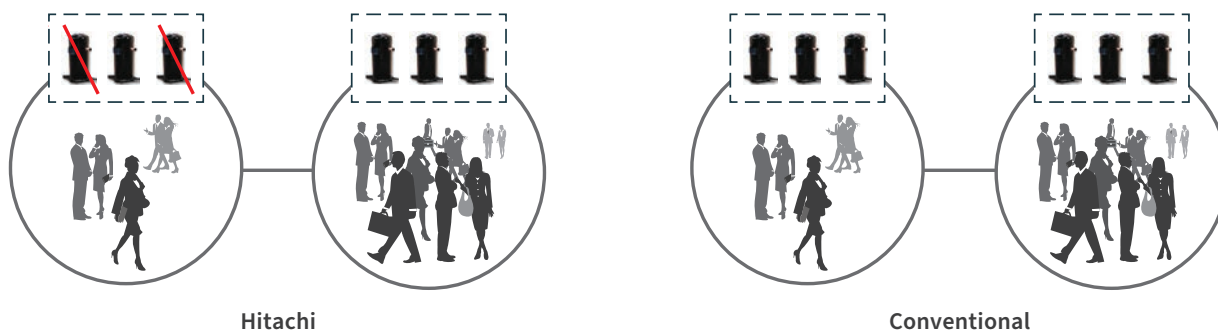

# What makes us different

## Silent Operation



The unique blower housing with increased suction and discharge areas provides uniform airflow. The new two-piece volute design also minimizes air turbulence resulting in a quieter operation.

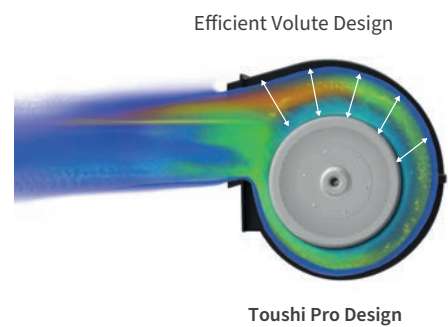
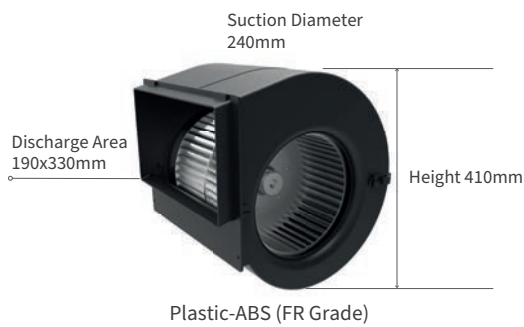

## Remote controller



Introducing new wireless remote controller along with standard wired controller.

### Key features:

- Seven segment display
- Wireless remote sensing\*
- Modes: Cool & Fan
- Room temperature setting 16<sup>o</sup> C to 30<sup>o</sup> C
- Room and set temperature display\*
- 12 hour off timer
- Self-diagnosis\*
- Manual compressor selection option in multi circuit unit\*
- Compressor run time indication\*



Wired Remote



Wireless Remote

\* Applicable for wired Remote

## Flexibility in convertible IDU



Looking at the space constraints, the 15.1 TR unit of the Toshi Pro series has been specially designed with a convertible fan compartment and coil compartment. The same indoor unit can thus be used as floor mounted or ceiling suspended. The advantage of floor mounted installation is that there will be no trap door in the occupied area and maintenance can be done easily in separate room. This innovative design gives the flexibility of installation for better management of space.

### Benefits

- Better space management
- Flexibility of installation
- Ease of service

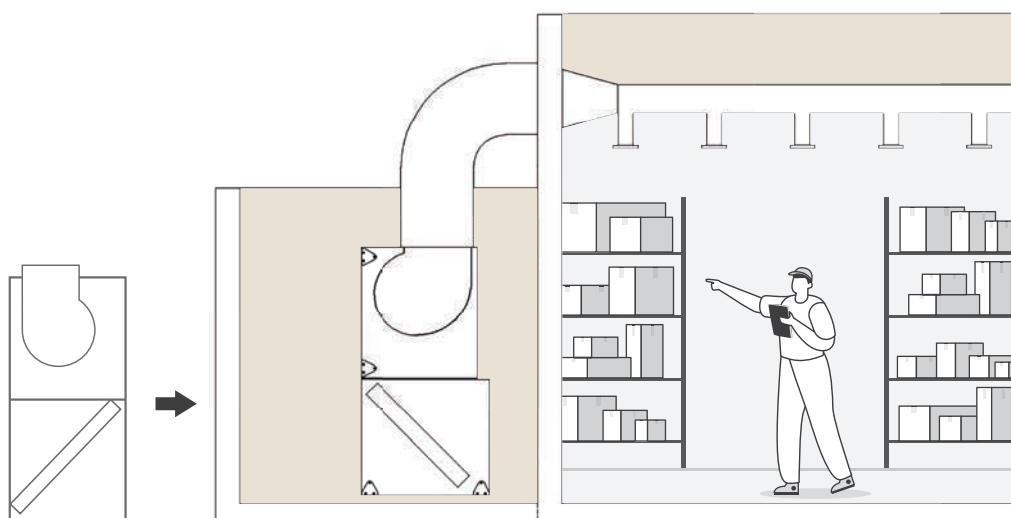

Indoor Unit  
Floor Mounted

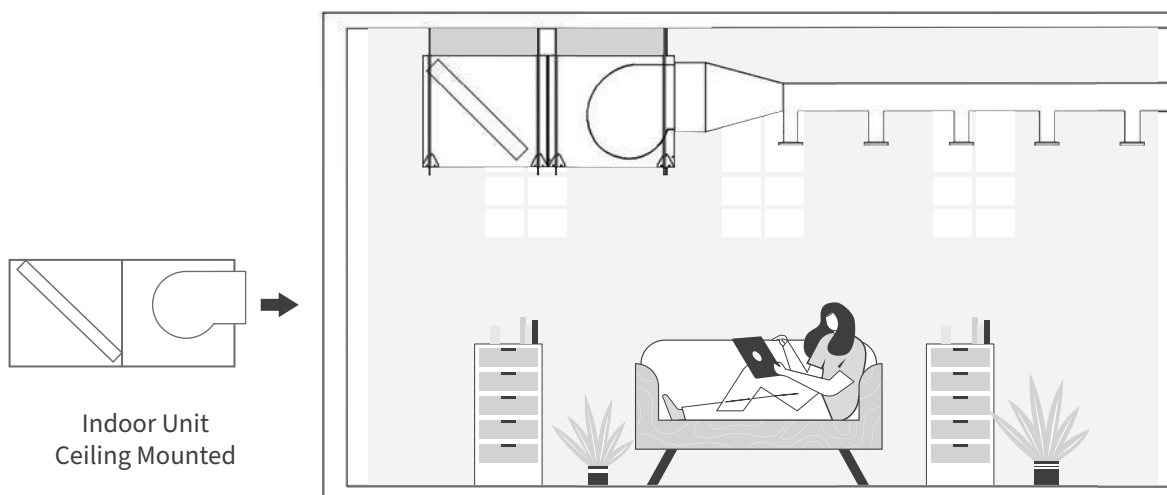

Indoor Unit  
Ceiling Mounted

## Advanced microprocessor controller



Advanced microprocessor controller safeguards compressor from the following:

### Over Current/Overload

Over current and overload protection safeguard equipment from excessive current flow. This protection reduces the risk of premature failure and need for frequent replacements and thus ensures longevity of equipment.

### Over/Under Voltage

In case of voltage fluctuations beyond range, the voltage sensing module on the controller provides safety to the system by cutting off the operation of the compressor. The system will auto restart when the voltage levels are back to normal operating range.

### Single Phase/Reverse Phase

Single phasing can cause overheating and can even damage the components while the Reverse phasing can lead to improper directional rotation of the motors. With single phase and reverse phase protection, reliability and safety of the system is ensured. System will auto restart once the fault is corrected or removed.

### High/Low Pressure

High and low pressure protection systems provide real-time monitoring and early detection of abnormal pressure conditions. This proactive approach allows for swift corrective actions and minimizes downtime of the unit. The system will auto restart once the fault is corrected or removed.

### Operational Safety

If the system goes in continuous overload/over current or high/low pressure fault for more than 3 successive retrials, the system will get locked for inspection/troubleshooting.

#### Benefits

- Low power consumption
- Increased life expectancy of unit
- Low maintenance cost

## Factory charged refrigerant

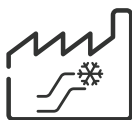

Hitachi ductable unit has factory charged refrigerant. All units are tested in factory under standard quality parameters, which ensures best performance of the units when installed. All units are equipped with service valve, which provides pump down of refrigerant and hassle-free relocation of the unit. A proper refrigerant charge is essential for efficient operation of the air conditioning system.

### Benefits

- Hassle-free relocation
- Reduces installation time
- Reduces error of incorrect refrigerant charge

## Anti-corrosive condenser fin coating\*

The anti-corrosion blue fin treatment of the heat exchanger increases corrosion resistant property. It is especially effective in coastal and urban areas with more humidity and weather conditions that corrode the exposed heat exchanger faster.

### Benefits

- Longer unit life.
- Blue fin have a 7 times higher salt spray resistant capacity in comparison to bare fin.

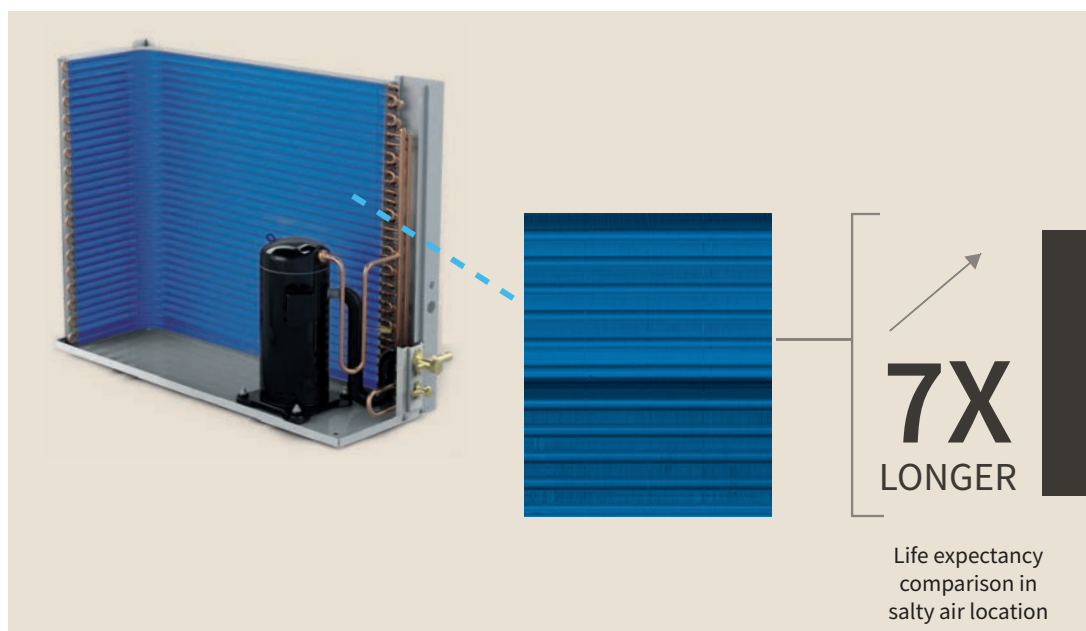

\*The anti-corrosive condenser fin coating is available in Tousei Pro ductable series only.

—  
Concealed split  
air conditioners



The indoor unit of Hitachi's Concealed Split AC is installed in the ceiling which blends with the interiors, thereby giving it an unobtrusive look. Its technological and aesthetical design makes it fit for large showrooms, hotels, shops, resorts, offices with cubicles and rooms with low ceiling. It is designed to produce horizontal airflow to combat the problems of large rooms having odd sized cabins or half portions. The Concealed Split AC is also equipped with efficiently designed heat exchangers that maximize cooling and reduce power consumption.

## Unique characteristics



### Kaimin Mode\*

Undisturbed sleep with power saving technology which ensures you get sound sleep by raising 1° C per hour upto 4 hrs. Now, enjoy more comfort with advanced energy savings.



### On/Off Timer with Advanced Start-Up

Desired comfort at desired time with scheduled start/stop function for better energy efficiency.



### Operating Mode

5 modes of operation- Cool, Fan, Dry, Auto and Powerful, for customized cooling.



### Auto Restart

When the power is restored, the AC restarts with the previous settings.



### Filter Clean Indicator

It indicates when the requirement of filter cleaning arises to maintain the efficiency of the machine.



### Silent Cooling

Enjoy peaceful cooling with optimum performance.



### High Ambient Design for 52° C Outdoor Air Temperature

Optimum cooling capacity in tropical temperatures.



### Twin Rotary Compressor#

Low vibration and noise levels.

\*Kaimin Mode is applicable only for Hitachi Wireless Concealed AC and in FSP wireless HAT Indoor. | #Twin Rotary Compressor is available with Hitachi Wired and Wireless models in 5.0 & 7.5 Tr only



—  
Flexi split  
air conditioners



Hitachi's Flexi Split Air Conditioners is an intelligent cooling solution that provides powerful performance while consuming less energy and space. As the name suggests, it offers flexibility to users to choose from the indoor units options as per the room/aesthetic requirements. Its single outdoor unit is capable of supporting up to 3 indoor units through independent circuits.

With all the advantages it offers, Hitachi's Flexi Split Air Conditioners is an ideal choice for light commercial applications like shops, showrooms, boutiques, hotels, resorts and more.

## Unique characteristics



**Control**  
• Individual remote with each IDU



**Flexibility**  
(Design Convenience)



**Easy Maintenance**

## Line up

### Common features



Tropical Design

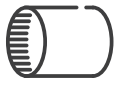

100% Copper



71 Quality Tests

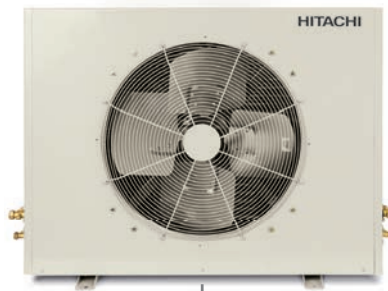

Cassette AC



Hi wall



In-the-ceiling



Fresh Air Intake



Sleep & Timer Control



Wave Blade Design



Filter Clean Indicator



On-off Timer With Advanced Start-up



Filter Clean Indicator



On-off Timer



Soft Dry



Auto Restart



Kaimin Mode\*

\* Kaimin Mode applicable only for FSP wireless HAT Indoor



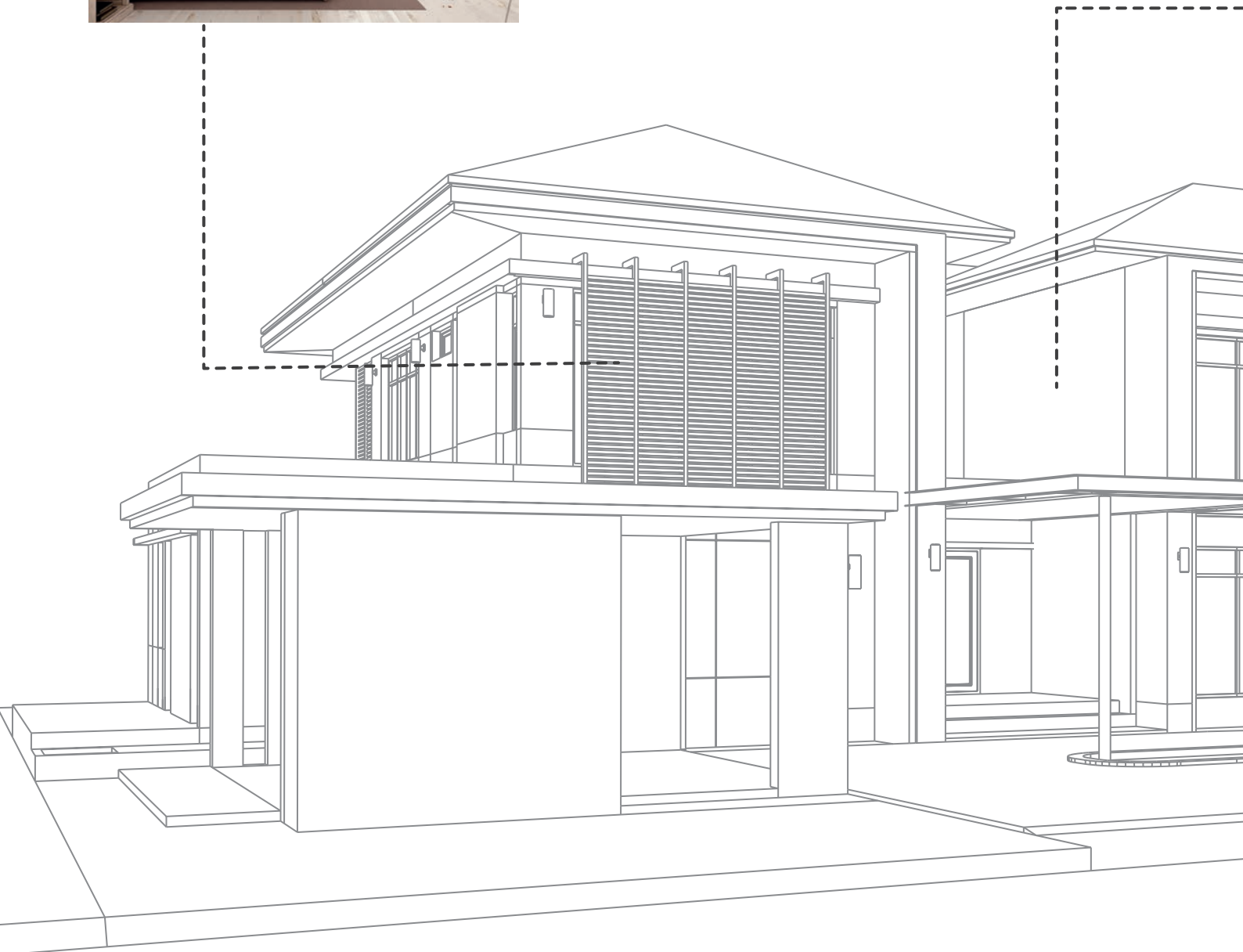

# Innovative cooling solutions for light commercial applications

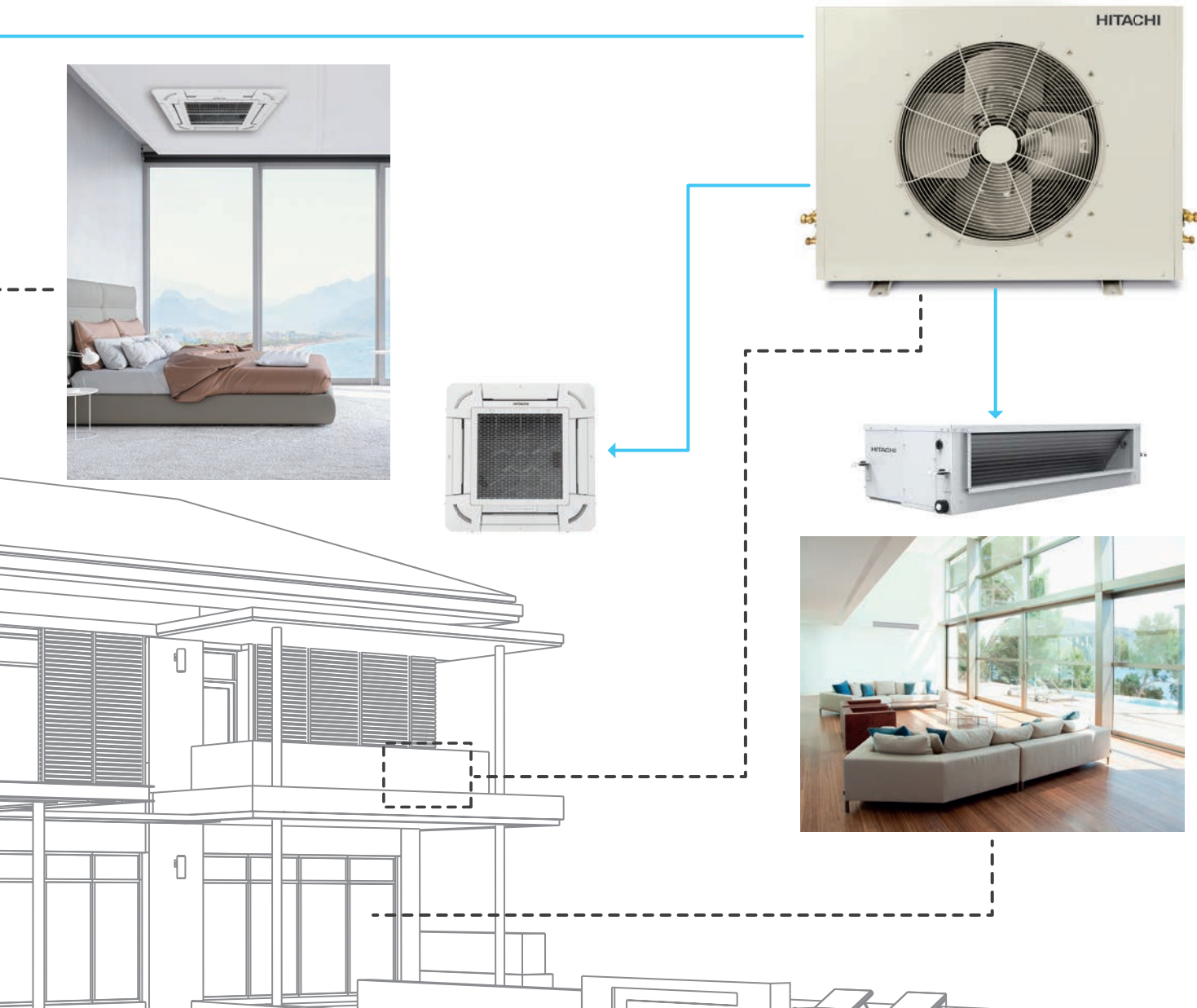

**Note:**

This is a visual representation of a Hitachi Flexi Split (FSP) Air Conditioner installed in a residential space like a villa.



| ODU (TR)  | Indoor Unit Options (TR)  |  |   | Combinations |
|---|---|--|---|--------------|
|  | Cassette<br> | Hi wall<br> | In-the-ceiling<br> |              |
| 3   | 1.5   | 1.5  | 1.5   | ANY 2        |
| 4   | 2   | 2  | 2   | ANY 2        |
| 5   | -   | -  | 2.5   | ANY 2        |
| 7.5   | -   | -  | 2.5   | ANY 3        |

The product line-up and availability may vary from the table shown above.

Cassette  
air conditioners



# Unique characteristics

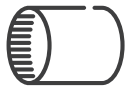

## 100% Inner Grooved Copper Tube

Inner grooved copper tubes for better heat exchange



## 71 Quality Tests

71 quality tests to ensure only the best quality product is delivered to you



## Remote Control

One touch handy operation to have access from anywhere in the room



## Auto Restart Function

Automatic restart function for increased comfort and safety.



## CASSETTE AC INVERTER SERIES



Expandable Inverter Air Conditioners



Fresh Air Intake Provision



Sleep & Timer Control



Dry Mode



Tropical Design



## CASSETTE AC FIXED SPEED SERIES



Tropical Design



Fresh Air Intake Provision



Sleep & Timer Control



Dry Mode



# Specifications

## Ductable air conditioner

### Toushi Pro series: R410A

| Model Name                          |      | PAG036SRHDDA3         | PAG066SSHDDA3         | PAG102SRHDDA3         | PAG102SSHDDA3Z1       | PAG120SSHDDA3Z1             | PAG186SSHDDA3                  | PAG186SSHDDA3Z4  |
|-------------------------------------|------|-----------------------|-----------------------|-----------------------|-----------------------|-----------------------------|--------------------------------|--|
| Rated Cooling Capacity* W           |      | 10551                 | 17937                 | 29895                 | 29895                 | 35170                       | 53107                          | 53107  |
| Compressor Type                     | Type | Twin Rotary           | Scroll                | Twin Rotary           | Scroll                | Scroll                      | Scroll                         | Scroll   |
| No. of Compressors                  | Nos. | 1                     | 1                     | 2                     | 2                     | 2                           | 3                              | 3  |
| Airflow                             | CFM  | 1200                  | 2200                  | 3400                  | 3400                  | 4000                        | 5400                           | 6350   |
| ESP                                 | Pa   | 20                    | 30                    | 30                    | 30                    | 40                          | 40                             | 100  |
| Outdoor Ambient Working Temp. Range | °C   | 21 ~ 52               | 21 ~ 52               | 21 ~ 52               | 21 ~ 52               | 21 ~ 52                     | 21 ~ 52                        | 21 ~ 52  |
| Power Supply                        |      | 230 V, 1Phase, 50 Hz. | 400 V, 3Phase, 50 Hz. | 400 V, 3Phase, 50 Hz. | 400 V, 3Phase, 50 Hz. | 400 V, 3Phase, 50 Hz.       | 400 V, 3Phase, 50 Hz.          | 400 V, 3Phase, 50 Hz.  |
| <b>Indoor Unit</b>                  |      |                       |                       |                       |                       |                             |                                |  |
| No. of IDU                          | Nos. | 1                     | 1                     | 1                     | 1                     | 1                           | 1                              | 1  |
| Dimension (W x H x D)               | mm   | 1190 x 385 x 675      | 1190 x 385 x 675      | 1550 x 440 x 675      | 1550 x 440 x 675      | 1550 x 440 x 675            | 2040 x 550 x 1085              | Blower Unit:<br>1550 x 725 x 815<br>Coil Unit:<br>1550 x 725 x 800 |
| Packing Dimension (W x H x D)       | mm   | 1350 x 430 x 790      | 1350 x 430 x 790      | 1761 x 585 x 810      | 1761 x 585 x 810      | 1761 x 585 x 810            | 2375 x 600 x 1260              | Blower Unit:<br>1740 x 840 x 935<br>Coil Unit:<br>1740 x 840 x 935 |
| Weight (Net / Gross)                | kg   | 58 / 67               | 63 / 72               | 90 / 120              | 90 / 120              | 105 / 135                   | 192 / 275                      | Blower Unit: 149 / 185<br>Coil Unit: 102 / 137                     |
| <b>Outdoor Unit</b>                 |      |                       |                       |                       |                       |                             |                                |  |
| No. of ODU                          | Nos. | 1                     | 1                     | 1                     | 1                     | 2                           | 3                              | 3  |
| Dimension (W x H x D)               | mm   | 935 x 735 x 390       | 1110 x 905 x 395      | 1200 x 940 x 550      | 1200 x 940 x 550      | 1110 x 905 x 395<br>(2nos)  | 1110 x 905 x 395<br>(x 3 nos)  | 1110 x 905 x 395<br>(x 3 nos)                                      |
| Packing Dimension (W x H x D)       | mm   | 1045 x 870 x 530      | 1265 x 1050 x 500     | 1340 x 1040 x 647     | 1340 x 1040 x 647     | 1265 x 1050 x 500<br>(2nos) | 1265 x 1050 x 500<br>(x 3 nos) | 1265 x 1050 x 500<br>(x 3 nos)                                     |
| Weight (Net / Gross)                | kg   | 72 / 81               | 95 / 105              | 151 / 175             | 151 / 175             | 95 / 105                    | 95 / 105                       | 95 / 105   |
| Piping Diameter (Gas/Liquid)        | inch | 3/4" x 3/8"           | 7/8" x 1/2"           | 7/8" x 1/2"           | 7/8" x 1/2"           | 7/8" x 1/2"                 | 7/8" x 1/2"                    | 7/8" x 1/2"  |
| Remote Type                         | -    | Wired & Wireless      | Wired & Wireless      | Wired & Wireless      | Wired & Wireless      | Wired & Wireless            | Wired & Wireless               | Wired & Wireless   |

Notes : \*Given performance data as per IS-8148 Standard.



## Concealed split air conditioner

### R410A

|  |             | INVERTER SERIES       |                       | FIXED SPEED SERIES    |                       |                       |                       |
|--|-------------|-----------------------|-----------------------|-----------------------|-----------------------|-----------------------|-----------------------|
| <b>Model Name</b>                          |             | PAG018STHDEA          | PAG024STHDEA          | PAG018KVDA            | PAG024KVDA            | PAG018HVDA            | PAG024HVDA            |
| <b>Rated Cooling Capacity* W</b>           |             | 5000                  | 7032                  | 5276                  | 6600                  | 5276                  | 6600                  |
| <b>Compressor Type</b>                     | <b>Type</b> | Rotary                | Rotary                | Rotary                | Rotary                | Rotary                | Rotary                |
| <b>No. of Compressors</b>                  | <b>Nos.</b> | 1                     | 1                     | 1                     | 1                     | 1                     | 1                     |
| <b>ESP</b>                                 | <b>Pa</b>   | 10                    | 10                    | 10                    | 10                    | 10                    | 10                    |
| <b>Outdoor Ambient Working Temp. Range</b> | <b>°C</b>   | 21 ~ 52               | 21 ~ 52               | 21 ~ 52               | 21 ~ 52               | 21 ~ 52               | 21 ~ 52               |
| <b>Power Supply</b>                        |             | 230 V, 1Phase, 50 Hz. | 230 V, 1Phase, 50 Hz. | 230 V, 1Phase, 50 Hz. | 230 V, 1Phase, 50 Hz. | 230 V, 1Phase, 50 Hz. | 230 V, 1Phase, 50 Hz. |
| <b>Indoor Unit</b>                         |             |                       |                       |                       |                       |                       |                       |
| <b>Model Name</b>                          |             | PAH018STHDEA          | PAH024STHDEA          | PAH018HVDA            | PAH024KVDA            | PAH018HVDA            | PAH024HVDA            |
| <b>No. of IDU</b>                          | <b>Nos.</b> | 1                     | 1                     | 1                     | 1                     | 1                     | 1                     |
| <b>Airflow</b>                             | <b>CFM</b>  | 600                   | 800                   | 600                   | 800                   | 600                   | 800                   |
| <b>Dimension (W x H x D)</b>               | <b>mm</b>   | 1130 x 280 x 535      | 1130 x 280 x 535      | 1130 x 280 x 535      | 1130 x 280 x 535      | 1130 x 280 x 535      | 1130 x 280 x 535      |
| <b>Packing Dimension (W x H x D)</b>       | <b>mm</b>   | 1320 x 370 x 600      | 1320 x 370 x 600      | 1320 x 370 x 600      | 1320 x 370 x 600      | 1320 x 370 x 600      | 1320 x 370 x 600      |
| <b>Weight (Net / Gross)</b>                | <b>kg</b>   | 31 / 35               | 32 / 36               | 31 / 35               | 32 / 36               | 31 / 35               | 32 / 36               |
| <b>Outdoor Unit</b>                        |             |                       |                       |                       |                       |                       |                       |
| <b>Model Name</b>                          |             | PAO018HVDA            | PAO024STHDEA          | PAO018HVDA            | PAO024KVDA            | PAO018HVDA            | PAO024HVDA            |
| <b>No. of ODU</b>                          | <b>Nos.</b> | 1                     | 1                     | 1                     | 1                     | 1                     | 1                     |
| <b>Dimension (W x H x D)</b>               | <b>mm</b>   | 750 x 548 x 280       | 792 x 600 x 290       | 792 x 600 x 290       | 792 x 600 x 290       | 792 x 600 x 290       | 792 x 600 x 290       |
| <b>Packing dimension (W x H x D)</b>       | <b>mm</b>   | 930 x 602 x 410       | 957 x 650 x 413       | 957 x 650 x 413       | 957 x 650 x 413       | 957 x 650 x 413       | 957 x 650 x 413       |
| <b>Weight (Net / Gross)</b>                | <b>kg</b>   | 28 / 30               | 41 / 45               | 41 / 45               | 45 / 49               | 41 / 45               | 45 / 49               |
| <b>Piping Diameter (Gas/Liquid)</b>        | <b>inch</b> | 1/2" x 1/4"           | 1/4" x 5/8"           | 1/4" x 5/8"           | 1/4" x 5/8"           | 1/4" x 5/8"           | 1/4" x 5/8"           |
| <b>Remote Type</b>                         | <b>-</b>    | Wireless              | Wireless              | Wired                 | Wired                 | Wireless              | Wireless              |

## Flexi split air conditioner

### R410A

| <b>Tonnage</b>                      | <b>TR</b>      | 3.0             | 4.0             | 5.0              | 7.5              |
|-------------------------------------|----------------|-----------------|-----------------|------------------|------------------|
| <b>Rated Cooling Capacity</b>       | <b>BTU/Hr.</b> | 36000           | 48000           | 60000            | 90000            |
| <b>Compressor</b>                   | <b>Type</b>    | Rotary          | Rotary          | Twin Rotary      | Twin Rotary      |
| <b>No. of Compressors</b>           | <b>Nos.</b>    | 2               | 2               | 2                | 3                |
| <b>No. of IDU</b>                   | <b>Nos.</b>    | 2               | 2               | 2                | 3                |
| <b>Outdoor Unit</b>                 |                |                 |                 |                  |                  |
| <b>No. of ODU</b>                   | <b>Nos.</b>    | 1               | 1               | 1                | 1                |
| <b>Rated Power Supply</b>           | <b>V/Hz/P</b>  | 230/50/1        | 230/50/1        | 400/50/3         | 400/50/3         |
| <b>No. of Fans</b>                  | <b>Nos.</b>    | 1               | 1               | 1                | 1                |
| <b>Dimension (WxHxD)</b>            | <b>mm</b>      | 950 x 740 x 460 | 950 x 740 x 460 | 1100 x 905 x 395 | 1200 x 940 x 550 |
| <b>Net weight</b>                   | <b>kg</b>      | 87              | 93              | 100              | 153              |
| <b>Piping Diameter (Gas/Liquid)</b> | <b>inch</b>    | 5/8" & 1/4"     | 5/8" & 1/4"     | 5/8" & 3/8"      | 5/8" & 3/8"      |

| <b>Indoor unit</b>            |                | <b>Concealed Type</b> |                  |                  | <b>Hi-Wall Type</b> |                 | <b>Cassette Type</b> |                 |
|-------------------------------|----------------|-----------------------|------------------|------------------|---------------------|-----------------|----------------------|-----------------|
| <b>Tonnage</b>                | <b>TR</b>      | 1.5                   | 2.0              | 2.5              | 1.5                 | 2.0             | 1.5                  | 2.0             |
| <b>Rated Cooling Capacity</b> | <b>BTU/Hr.</b> | 18000                 | 24000            | 30000            | 18000               | 24000           | 18000                | 24000           |
| <b>Rated Power Supply</b>     | <b>V/Hz/P</b>  | 230/50/1              | 230/50/1         | 230/50/1         | 230/50/1            | 230/50/1        | 230/50/1             | 230/50/1        |
| <b>Air Flow</b>               | <b>CFM</b>     | 650                   | 800              | 1000             | 600                 | 650             | 550                  | 550             |
| <b>Dimension (WxHxD)</b>      | <b>mm</b>      | 1130 x 280 x 535      | 1130 x 280 x 535 | 1130 x 280 x 535 | 968 x 294 x 240     | 997 x 294 x 253 | 570 x 260 x 570      | 570 x 260 x 570 |
| <b>Net weight</b>             | <b>kg</b>      | 31                    | 32               | 32               | 11.9                | 13              | 19                   | 19              |

# Cassette air conditioner

|                                | DESCRIPTION                                 | UNIT               | FIXED SPEED SERIES |              |                     |                     |
|--------------------------------|---|--------------------|--------------------|--------------|---------------------|---------------------|
|                                | Model Number                                |                    | RAG318HGDOQ        | RAG222HGDOQ  | RAG136HGDA3Q        | RAG148HGDA3Q        |
| Details                        | Star Rating <sup>#</sup>                    |                    | 3                  | 2            | 1                   | 1                   |
|                                | Compressor                                  | Type / Refrigerant | Rotary / R32       | Rotary / R32 | Twin Rotary / R410A | Twin Rotary / R410A |
| Performance                    | Rated Cooling Capacity (100% load)          | BTU / Hr           | 18425              | 21496        | 35983               | 45789               |
|                                | Rated Cooling Capacity (100% load)          | Watts              | 5400               | 6300         | 10546               | 13420               |
|                                | Maximum Cooling Capacity                    | BTU/Hr             | -                  | -            | -                   | -                   |
|                                | Maximum Cooling Capacity                    | Watts              | -                  | -            | -                   | -                   |
|                                | Rated ISEER                                 |                    | 3.94               | 3.64         | 2.88                | 2.92                |
|                                | Annual Power Consumption (As per BEE norms) | (kWh)              | 1061               | 1339         | 2836                | 3561                |
|                                | Fan Speed                                   | No. of Steps       | 4                  | 4            | 4                   | 4                   |
|                                | Air Flow (IDU) (Cooling)                    | CFM (HIGH)         | 765                | 795          | 1235                | 1235                |
|                                | Sound Level **                              | dBA (L)            | 43                 | 43           | 49                  | 49                  |
| Electrical                     | Rated Power Input - Cooling                 | Watts              | 1370               | 1730         | 3664                | 4600                |
|                                | Rated Power Supply                          | Volts / Hz / Phase | 230 / 50 / 1       | 230 / 50 / 1 | 400 / 50 / 3        | 400 / 50 / 3        |
|                                | Rated Current Drawn                         | Amps               | 6.3                | 7.9          | 5.58 / Phase        | 6.98 / Phase        |
| Advanced Features              | Piping Diameter (Gas/Liquid)                | inch               | 1/2" x 1/4"        | 1/2" x 1/4"  | 3/4" x 3/8"         | 3/4" x 3/8"         |
|                                | Remote                                      | Type               | Wireless           | Wireless     | Wireless            | Wireless            |
|                                | Expandable                                  |                    | -                  | -            | -                   | -                   |
|                                | Fresh Air Intake Provision                  |                    | ✓                  | ✓            | ✓                   | ✓                   |
|                                | Sleep & Timer Control                       |                    | ✓                  | ✓            | ✓                   | ✓                   |
|                                | On / Off Timer                              |                    | ✓                  | ✓            | ✓                   | ✓                   |
|                                | Dry Mode                                    |                    | ✓                  | ✓            | ✓                   | ✓                   |
|                                | Energy Saver Mode                           |                    | ✓                  | ✓            | ✓                   | ✓                   |
|                                | Auto Restart                                |                    | ✓                  | ✓            | ✓                   | ✓                   |
| Tropical Design <sup>###</sup> |   | ✓                  | ✓                  | ✓            | ✓                   |                     |
| Dimension                      | Dimension (IDU) (WxHxD)                     | mm                 | 845x245x845        | 845x245x845  | 845x290x845         | 845x290x845         |
|                                | Dimension (ODU) (WxHxD)                     | mm                 | 792x600x299        | 792x600x299  | 935x735x390         | 935x735x390         |
|                                | Dimension (Panel) (WxHxD)                   | mm                 | 950x52x950         | 950x52x950   | 950x52x950          | 950x52x950          |
|                                | Net Weight-IDU / ODU                        | kg                 | 22/42              | 24/43        | 26/72               | 26/80               |

## Notes:

- Cooling capacity is based on: indoor temp. 27°C DB, 19°C WB; outdoor temp. 35°C DB, at standard piping length of 5m.
- Features may vary from model to model.
- Images of Remote & Indoor Unit units are just for representation purposes only; the actual product appearance may vary from model to model.
- Due to continuous research & development, specifications, features and looks may change without prior notice.
- # Star rating mentioned as per BEE norms of 2023. Rated capacities above 10500W up to and including 18000W follow the LCAC star rating.
- ## Sound level measured as per standard test conditions at the lowest fan speed.
- ### Hitachi Cassette Fixed Speed AC is designed to work in ambient temperatures up to 52°C.

# Specifications

## Cassette air conditioner

|                                | DESCRIPTION                                 | UNIT               | INVERTER SERIES   |                   |
|--------------------------------|---|--------------------|-------------------|-------------------|
|                                | Model Number                                |                    | RAG418HGEOO       | RAG422HGEOO       |
| Details                        | Star Rating <sup>#</sup>                    |                    | 4                 | 4                 |
|                                | Compressor                                  | Type / Refrigerant | Twin Rotary / R32 | Twin Rotary / R32 |
| Performance                    | Rated Cooling Capacity (100% load)          | BTU / Hr           | 18595             | 21154             |
|                                | Rated Cooling Capacity (100% load)          | Watts              | 5450              | 6200              |
|                                | Maximum Cooling Capacity                    | BTU/Hr             | 19642             | 22903             |
|                                | Maximum Cooling Capacity                    | Watts              | 5757              | 6712              |
|                                | Rated ISEER                                 |                    | 4.60              | 4.60              |
|                                | Annual Power Consumption (As per BEE norms) | (kWh)              | 918               | 1043              |
|                                | Fan Speed                                   | No. of Steps       | 4                 | 4                 |
|                                | Air Flow (IDU) (Cooling)                    | CFM (HIGH)         | 718               | 753               |
|                                | Sound Level <sup>**</sup>                   | dB(A) (L)          | 41                | 41                |
| Electrical                     | Rated Power Input - Cooling                 | Watts              | 1540              | 1745              |
|                                | Rated Power Supply                          | Volts / Hz / Phase | 230 / 50 / 1      | 230 / 50 / 1      |
|                                | Rated Current Drawn                         | Amps               | 7.1               | 8.0               |
| Advanced Features              | Piping Diameter (Gas/Liquid)                | inch               | 1/2" x 1/4"       | 5/8" x 1/4"       |
|                                | Remote                                      | Type               | Wireless          | Wireless          |
|                                | Expandable                                  |                    | ✓                 | ✓                 |
|                                | Fresh Air Intake Provision                  |                    | ✓                 | ✓                 |
|                                | Sleep & Timer Control                       |                    | ✓                 | ✓                 |
|                                | On / Off Timer                              |                    | ✓                 | ✓                 |
|                                | Dry Mode                                    |                    | ✓                 | ✓                 |
|                                | Energy Saver Mode                           |                    | ✓                 | ✓                 |
|                                | Auto Restart                                |                    | ✓                 | ✓                 |
| Tropical Design <sup>###</sup> |   | ✓                  | ✓                 |                   |
| Dimension                      | Dimension (IDU) (WxHxD)                     | mm                 | 845x245x845       | 845x245x845       |
|                                | Dimension (ODU) (WxHxD)                     | mm                 | 781x555x281       | 781x555x281       |
|                                | Dimension (Panel) (WxHxD)                   | mm                 | 950x52x950        | 950x52x950        |
|                                | Net Weight-IDU / ODU                        | kg                 | 23/27             | 24/28             |

### Notes:

- Cooling capacity is based on: indoor temp. 27°C DB, 19°C WB; outdoor temp. 35°C DB, at a standard piping length of 5m.

- Features may vary from model to model.

- Images of Remote & Indoor Unit units are just for representation purposes only; the actual product appearance may vary from model to model.

- Due to continuous research & development, specifications, features, and looks may change without prior notice.

# Star rating mentioned as per BEE norms of 2023. Rated capacities above 10500W up to and including 18000W follow the LCAC star rating.

## Sound level measured as per standard test conditions at the lowest fan speed.

### Hitachi Cassette Inverter ACs are designed to work at ambient temperatures up to 48°C.



## Johnson Controls-Hitachi Air Conditioning India Limited

### HEAD OFFICE

Hitachi Complex, Karan Nagar, Kadi,  
Dist.- Mehsana - 384440, Gujarat, India.

Email: [sales@jci-hitachi.com](mailto:sales@jci-hitachi.com)  
Website: [www.hitachiaircon.in](http://www.hitachiaircon.in)



Call: 079-7141-4848 (Landline)  
Mobile/WhatsApp: 756788-4848  
E-mail: [customercare@jci-hitachi.com](mailto:customercare@jci-hitachi.com)

### REGISTERED OFFICE

Abhijeet - I, 9th Floor, 903-904,  
Mithakhali Six Road, Navrangpura,  
Ahmedabad - 380 006, Gujarat, India.

CIN No. L29300GJ1984PLC007470

 This is an e-waste product and should not be mixed with general household waste at the end of its life. For more details kindly visit our website or contact Hitachi Dial-a-Care.

Join us at:  <https://www.facebook.com/HitachiHomes/>  <https://twitter.com/HitachiHomes>  <https://www.youtube.com/user/hitachihome>  <https://www.linkedin.com/company/johnson-controls-hitachi-air-conditioning>  Live Chat at [www.hitachiaircon.in](http://www.hitachiaircon.in)  Download Hitachi iCare App  

Due to continuous research & development, the product specification and features as mentioned in this catalog may change without prior notice. The information/recommendations contained in this catalogue are merely suggestive. Johnson Controls - Hitachi Air Conditioning India Limited declines any responsibility in the broadest sense, for any loss/damage, direct or indirect, arising from the use and / or interpretation of the recommendations in this catalog.

**Discover Hitachi Cooling & Heating products  
accompanied by exceptional service at your  
nearest Hitachi dealer.**